



## COUNTY OF SAN JOAQUIN

DEPARTMENT OF PUBLIC WORKS  
P.O. BOX 1810-1810 E. HAZELTON AVENUE  
STOCKTON, CALIFORNIA 95201  
(209) 468-3000  
FAX # (209) 468-9324

Permit No: **PS-1603487**  
Date Issued: 11/03/2016  
Start Date: 12/03/2016  
Exp. Date: 12/03/2016  
Project No: PWP110005  
Quad: NE

### ENCROACHMENT PERMIT

To: LINDEN-PETERS CHAMBER OF COMMERCE  
P.O. BOX 3  
LINDEN, CA 95236

**Encroachment Type:**

Temporary Road Closure			
------------------------	--	--	--

**Location:**

FRONT STREET BETWEEN BONHAM STREET AND MILLS STREET

In compliance with your request of **11/03/2016**, permission is hereby granted to do work in County right-of-way as shown on attached application and subject to all the terms, conditions and restrictions written below or printed as general or special provisions on any part of this form. See reverse side and attached sheet, if any.

Trench excavations for service connections will not be permitted within ten feet (10') of pavement centerline unless otherwise approved by the Director. Surface of trench patches shall match in kind and be smooth and even with that of abutting surface. Special attention shall be given to depth of utilities through roadside area in anticipation of future drainage facilities, road profile and/or frontage development. All underground utility facilities are to be established and accurately dimensioned on sketches from surveyed centerline of road right of way, or from right of way (border) lines.

Permittee shall call the Department of Public Works, Field Engineering Division (Permit Inspections) at (209)953-7421 at least forty-eight hours prior to beginning any work within the County right of way. All work performed under this permit shall conform to the rules and regulations pertaining to safety established by the California Division of Industrial Safety and Cal-OSHA.

The jobsite shall be kept in a safe condition at all times by the daily removal of any excess dirt or debris which might be a hazard to either pedestrian or automobile traffic. All necessary traffic convenience and warning devices and personnel shall be provided, placed and maintained by and at the sole expense of the Permittee in accordance with the latest edition of the CALTRANS Manual of Traffic Control.

After completion of the work permitted herein, all debris, lumber, barricades, or any excess material shall be removed and the jobsite left in a neat workmanlike manner. Immediately following completion of construction permitted herein, Permittee shall fill out and mail notice of completion (see attached post card) provided by Grantor.

**Special Comments:**

Traffic Control Per MUTCD\*\*\*\*Temporary Road Closure on Front St. between Bonham St. and Mills St. on December 3, 2016 from 5:00pm to 8:30pm for the Holiday Celebration Ceremony\*\*\*\*\*

**FORMS:**

--	--	--

Est. Permit Fee: \$0.00

WHITE	-Permittee
GOLDENROD	-PWD Central File
YELLOW	-Field Inspection
PINK	-Permit Section

KRIS BALAJI, Director  
Department of Public Works

By:   
Permit Section



## ENCROACHMENT PERMIT GENERAL PROVISIONS

13-1.

1. This permit is issued under and subject to all laws and ordinances of agencies governing the encroachment herein permitted. See the following references:

### STREETS AND HIGHWAYS CODE

1. Division 1, Chapter 3
2. Division 2, Chapter 2, Section 942
3. Division 2, Chapter 4, Section 1126
4. Division 2, Chapter 5.5 and Chapter 6

SAN JOAQUIN COUNTY ORDINANCES NUMBERED: 324, 441, 548, 662, 672, 695, 700, 860, 892, 3359, and 3675.

2. It is understood and agreed by the Permittee that the performance of any work under this permit shall constitute an acceptance of all the provisions contained herein and failure on the Permittee's part to comply with any provision will be cause for revocation of this permit. Except as otherwise provided for public agencies and franchise holders, this permit is revocable on five days notice.
3. All work shall be done subject to the supervision of and the satisfaction of the grantor. The Permittee shall at all times during the progress of the work keep the County Highway in as neat and clean condition as is possible and upon completion of the work authorized herein, shall leave the County Highway in a thoroughly neat, clean and usable condition.
4. The Permittee also agrees by the acceptance of this permit to properly maintain any encroachment structure placed by the Permittee on any part of the County Highway and to immediately repair any damage to any portion of the highway, which occurs as a result of the maintenance of the said encroachment structure, until such time as the Permittee may be relieved of the responsibility for such maintenance by the County of San Joaquin.
5. The Permittee also agrees by the acceptance of this permit to make, at its own expense, such repairs as may be deemed necessary by the County Department of Public Works.
6. It is further agreed by the Permittee that whenever construction, reconstruction or maintenance work upon the highway is necessary, the installation provided for herein shall, upon request of the County Department of Public Works, be immediately moved or removed by and at the sole expense of the Permittee.
7. No material used for fill or backfill in the construction of the encroachment shall be borrowed or taken from within the County right of way.
8. All work shall be planned and carried out with as little inconvenience as possible to the traveling public. No material shall be stacked within eight feet (8') of the edge of the pavement or traveled way unless otherwise provided herein. Adequate provision shall be made for the protection of the traveling public. Traffic control standards shall be utilized including barricades; approved signs and lights; and flagmen, as required by the particular work in progress.
9. The Permittee, by the acceptance of this permit, shall assume full responsibility for all liability for personal injury or damage to property which may arise out of the work herein permitted or which may arise out of the failure of the part of the Permittee to properly perform the work provided under this permit. In the event any claim of such liability is made against the County of San Joaquin or any department, official or employee thereof, the Permittee shall defend, indemnify, and hold each of them harmless for such claim.
10. All backfill material is to be moistened as necessary and thoroughly compacted with mechanical means. If required by the County Director of Public Works, such backfill shall consist of gravel or crushed rock. The Permittee shall maintain the surface over structures placed hereunder as may be necessary to insure the return of the roadway to a completely stable condition and until relieved of such responsibility by the County Department of Public Works. Wherever a gravel, crushed rock or asphalt surface is removed or damaged in the course of work related to the permitted encroachment, such material shall either be separately stored and replaced in the roadway as nearly as possible in its original state or shall be replaced in kind, and the roadway shall be left in at least as good a condition as it was before the commencement of operations of placing the encroachment structure.
11. Whenever it becomes necessary to secure permission from abutting property owners for the proposed work, such authority must be secured by the Permittee prior to starting work.
12. The current and future safety and convenience of the traveling public shall be given every consideration in the location and methods of construction utilized.
13. The Permittee is responsible for the preservation of survey monuments located within the area of work herein permitted. Prior to the start of construction, survey monuments that potentially may be disturbed shall be located and referenced by a Licensed Land Surveyor, and a Corner Record filed with the County Surveyor. Any Survey Monuments disturbed during the course of construction shall be reestablished by a Licensed Land Surveyor and another Corner Record filed with the County Surveyor. (Land Surveyors' Act Section 8771)
14. Prior to any excavation, the Permittee shall notify USA North (Underground Service Alert of Northern California and Nevada) at 811 or 800-227-2600 forty-eight (48) hours in advance.

SPECIAL CONDITIONS FOR  
LINDEN HOLIDAY CELEBRATION AND TREE LIGHTING CEREMONY  
ENCROACHMENT PERMIT

1. Traffic control shall be in accordance with the attached traffic handling plan.
2. The traffic handling at designated intersections shall be provided by Linden Fire Department.
3. Applicant shall notify and coordinate with all emergency services (fire, police, etc.) a minimum of seven days prior to the event.
4. Event signage shall include locations for designated off-street parking.
5. Emergency vehicle and local resident access shall be provided at all times.
6. A certificate of insurance, naming San Joaquin County as additional insured and certificate holder, must be submitted to the County prior to the event.
7. Marking of pavement (e.g., paint) is not allowed.
8. Roadway shall be completely cleared and open to the travelling public by 8:30 pm. All related signage shall be removed by 9:00 pm.
9. The applicant shall immediately make such repairs and/or perform any necessary work required to leave the County roadways designated under this permit in as neat, clean and usable condition as existed prior to the encroachment.



# APPLICATION FOR ENCROACHMENT PERMIT

**PLEASE PRINT:**

Date 11-3-16

To: San Joaquin County  
Department of Public Works

LINDEN-PETERS CHAMBER OF COMMERCE  
(Applicant Name)

C/O VIC SOLARI

P.O. BOX 3

(Mailing Address)

LINDEN, CA 95236

(City, State, Zip Code)

209-482-6487

(Area Code - Telephone Number)

**OFFICE USE ONLY**

JOB # 110005 REF # \_\_\_\_\_  
APN \_\_\_\_\_ CR # \_\_\_\_\_  
EXP. DATE 12/3/16  
VALID 12/3/16 TO 12/3/16 DRIVEWAYS:  
STREET FRONT STREET \* \_\_\_\_\_  
AREA LINDEN QUAD NE \* \_\_\_\_\_  
TYPE TEMP. ROAD CLOSURE \* \_\_\_\_\_  
FORMS —  
NOTES \_\_\_\_\_

HOLIDAY CELEBRATION - TREE LIGHTING  
CEREMONY DECEMBER 3, 2016  
5:00 PM TO 8:30 PM

Sketch (Detailed plans may be submitted)

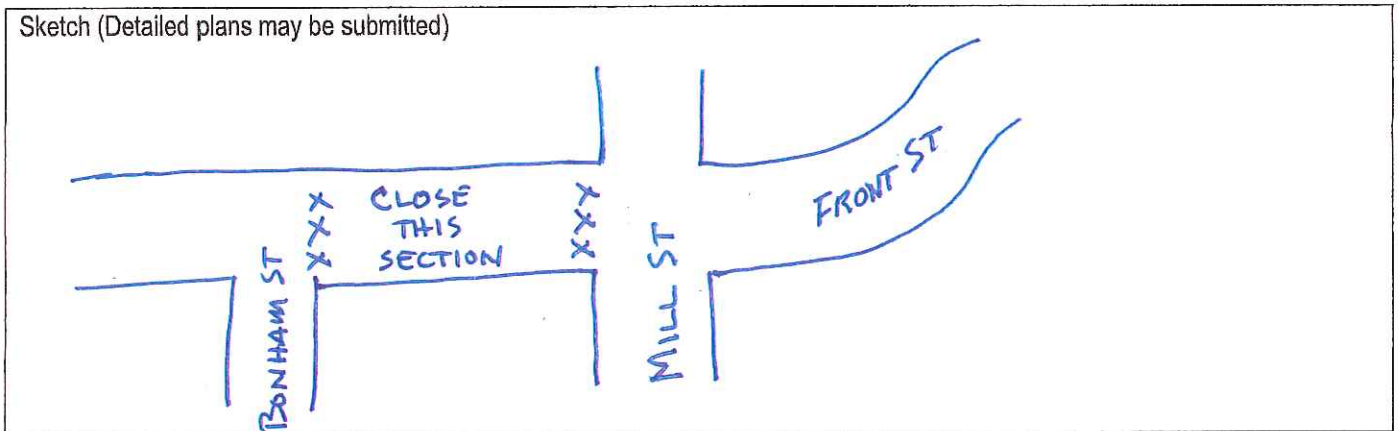

The undersigned hereby applies for permission to excavate, construct and/or otherwise encroach on County Highway Right-of-Way on the BOTH side of LANES OF FRONT ST. approximately \_\_\_\_\_ feet/mile of \_\_\_\_\_, by performing the following work (description of work):

BETWEEN BONHAM ST. + MILL ST ON DECEMBER 3, 2016 FROM  
5:00 P.M. - 8:30 P.M. FOR HOLIDAY CELEBRATION ATTENDED BY  
THE LINDEN COMMUNITY

Work will commence on or about DECEMBER 3, 2016 for approximately 3 1/2 HOURS days.

I, the undersigned, certify that I am the owner of the respective property, or am qualified to represent the owner and agree to do the work described above in accordance with the rules and regulations of San Joaquin County and subject to inspection and approval.

[Signature] BOARD MEMBER  
Signature of Applicant - Title

11-3-16  
Date

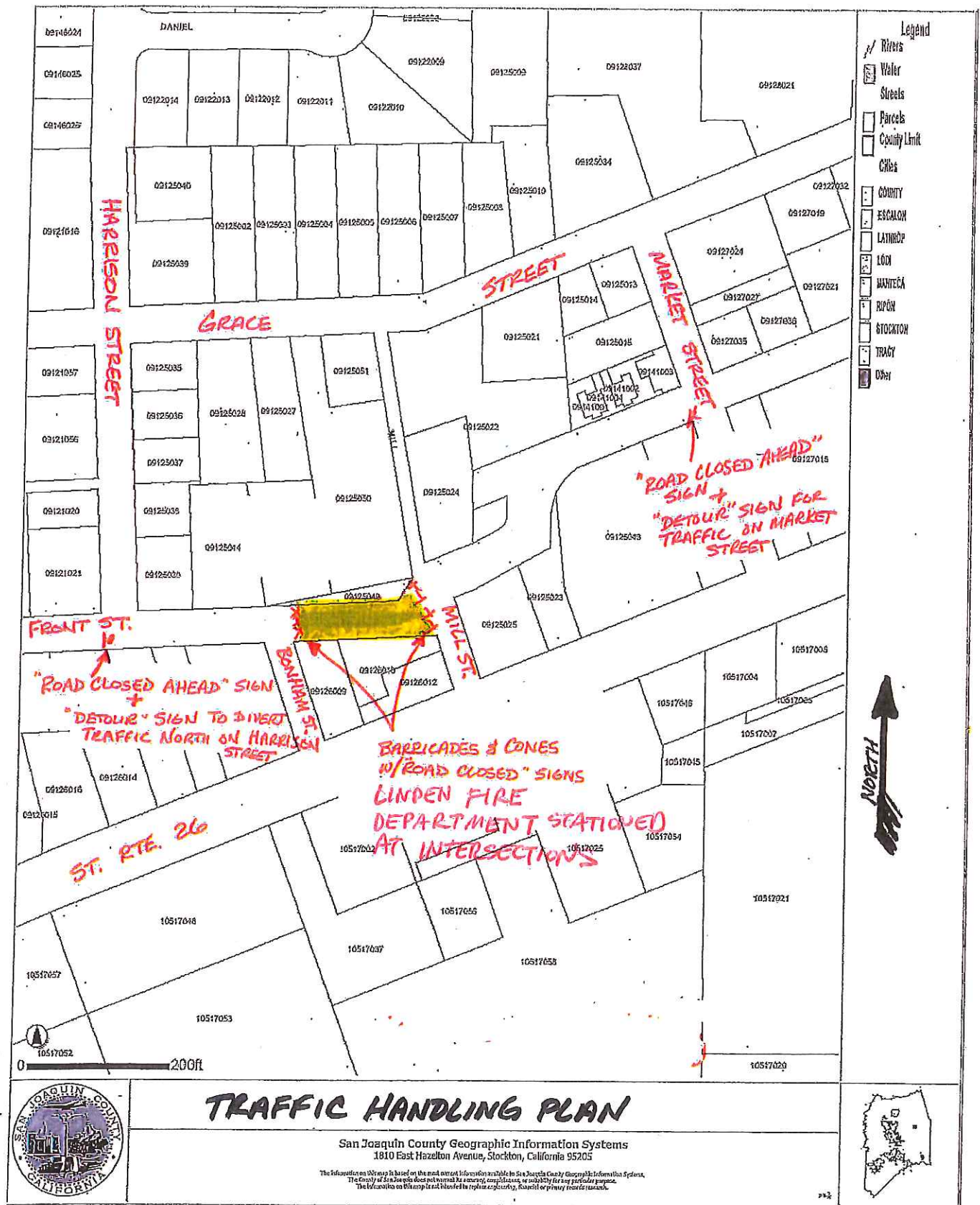

**[Yellow Highlighted Area] = CLOSED PORTION OF FRONT STREET**



1925

ЭНИМДЭГДЭЙН ДЭЛЭГ

JUL 28 1999

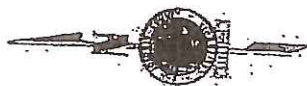

FOR SEC. 15 T. 2N. R. 3E  
BLOCKS 2 & 5 UNDER

SCALE 1" = 100'  
SAN JOAQUIN COUNTY  
ASSESSOR'S MAPS

A. P. M. Bk. 4. p. 9. 123  
B. P. M. Bk. 6. p. 9. 15.  
C. P. M. Bk. 6. p. 9. 109

Case A-19-19-12  
S. L. N. A. G. L.

1961  
1962

21-05-2012

*M. J. G.*

ANAL. Calcd. for  $C_{10}H_{12}O$ : C, 85.7%; H, 8.6%.

2019-2020

١٠٨٩  
١٠٩٠

N. (MONTAGNA) HALL AT JEWELL LEMING & SULLIVAN Bldg  
d. EDWARDS - PLANNED  
SENIOR & COMES SENIORS ROOMS across road from  
REARDOCK

[illegible]

2015  
JAN 29

15. 12. 1942





# CERTIFICATE OF LIABILITY INSURANCE

DATE (MM/DD/YYYY)

10/27/2016

THIS CERTIFICATE IS ISSUED AS A MATTER OF INFORMATION ONLY AND CONFERS NO RIGHTS UPON THE CERTIFICATE HOLDER. THIS CERTIFICATE DOES NOT AFFIRMATIVELY OR NEGATIVELY AMEND, EXTEND OR ALTER THE COVERAGE AFFORDED BY THE POLICIES BELOW. THIS CERTIFICATE OF INSURANCE DOES NOT CONSTITUTE A CONTRACT BETWEEN THE ISSUING INSURER(S), AUTHORIZED REPRESENTATIVE OR PRODUCER, AND THE CERTIFICATE HOLDER.

IMPORTANT: If the certificate holder is an ADDITIONAL INSURED, the policy(ies) must be endorsed. If SUBROGATION IS WAIVED, subject to the terms and conditions of the policy, certain policies may require an endorsement. A statement on this certificate does not confer rights to the certificate holder in lieu of such endorsement(s).

PRODUCER Mid-Central Valley Insurance Lic #0795406 301 South Ham Lane, Suite F Lodi CA 95241	CONTACT NAME: CLC PHONE (A/C, No, Ext): 855-297-3238 E-MAIL: clcunited@leavitt.com ADDRESS: clcunited@leavitt.com	FAX (A/C, No): 866-688-5709
INSURED Linden-Peters Chamber of Commerce P. O. Box 557 Linden CA 95236	INSURER(S) AFFORDING COVERAGE INSURER A: Nautilus Insurance Company INSURER B: Great American Insurance Company INSURER C: INSURER D: INSURER E: INSURER F:	

## COVERAGES

CERTIFICATE NUMBER: CL16102703186

REVISION NUMBER:

THIS IS TO CERTIFY THAT THE POLICIES OF INSURANCE LISTED BELOW HAVE BEEN ISSUED TO THE INSURED NAMED ABOVE FOR THE POLICY PERIOD INDICATED. NOTWITHSTANDING ANY REQUIREMENT, TERM OR CONDITION OF ANY CONTRACT OR OTHER DOCUMENT WITH RESPECT TO WHICH THIS CERTIFICATE MAY BE ISSUED OR MAY PERTAIN, THE INSURANCE AFFORDED BY THE POLICIES DESCRIBED HEREIN IS SUBJECT TO ALL THE TERMS, EXCLUSIONS AND CONDITIONS OF SUCH POLICIES. LIMITS SHOWN MAY HAVE BEEN REDUCED BY PAID CLAIMS.

INSR LTR	TYPE OF INSURANCE	ADDL SUBR INSD WVD	POLICY NUMBER	POLICY EFF (MM/DD/YYYY)	POLICY EXP (MM/DD/YYYY)	LIMITS
A	<input checked="" type="checkbox"/> COMMERCIAL GENERAL LIABILITY <input type="checkbox"/> CLAIMS-MADE <input checked="" type="checkbox"/> OCCUR GEN'L AGGREGATE LIMIT APPLIES PER: <input checked="" type="checkbox"/> POLICY <input type="checkbox"/> PRO-JECT <input type="checkbox"/> LOC OTHER:	X	NN709456	11/1/2016	11/1/2017	EACH OCCURRENCE \$ 1,000,000 DAMAGE TO RENTED PREMISES (Ea occurrence) \$ 100,000 MED EXP (Any one person) \$ 5,000 PERSONAL & ADV INJURY \$ 1,000,000 GENERAL AGGREGATE \$ 2,000,000 PRODUCTS - COMP/OP AGG \$ INCLUDED \$
	AUTOMOBILE LIABILITY <input type="checkbox"/> ANY AUTO <input type="checkbox"/> ALL OWNED AUTOS <input type="checkbox"/> HIRED AUTOS <input type="checkbox"/> SCHEDULED AUTOS <input type="checkbox"/> NON-OWNED AUTOS					COMBINED SINGLE LIMIT (Ea accident) \$ BODILY INJURY (Per person) \$ BODILY INJURY (Per accident) \$ PROPERTY DAMAGE (Per accident) \$ \$
	UMBRELLA LIAB EXCESS LIAB DED RETENTION \$	<input type="checkbox"/> OCCUR <input type="checkbox"/> CLAIMS-MADE				EACH OCCURRENCE \$ AGGREGATE \$ \$
	WORKERS COMPENSATION AND EMPLOYERS' LIABILITY ANY PROPRIETOR/PARTNER/EXECUTIVE OFFICER/MEMBER EXCLUDED? (Mandatory in NH) If yes, describe under DESCRIPTION OF OPERATIONS below	Y/N <input type="checkbox"/> N/A				PER STATUTE OTH-ER E.L. EACH ACCIDENT \$ E.L. DISEASE - EA EMPLOYEE \$ E.L. DISEASE - POLICY LIMIT \$
B	DIRECTORS & OFFICERS LIABILITY & EPLI		EPP6181254-03	11/1/2016	11/1/2017	EACH CLAIM \$ 1,000,000 AGGREGATE \$ 1,000,000

DESCRIPTION OF OPERATIONS / LOCATIONS / VEHICLES (ACORD 101, Additional Remarks Schedule, may be attached if more space is required)

Linden-Peters Chamber of Commerce Tree Lighting Ceremony 2016.

San Joaquin County is additional insured for Commercial General Liability per attached CG2011 01 96 endorsement.

## CERTIFICATE HOLDER

## CANCELLATION

San Joaquin County  
1810 E. Hazelton Ave.  
Stockton, CA 95205

SHOULD ANY OF THE ABOVE DESCRIBED POLICIES BE CANCELLED BEFORE THE EXPIRATION DATE THEREOF, NOTICE WILL BE DELIVERED IN ACCORDANCE WITH THE POLICY PROVISIONS.

AUTHORIZED REPRESENTATIVE

L zcCraig/LICRAI

© 1988-2014 ACORD CORPORATION. All rights reserved.